

KEMBLA

TIN COATED COPPER REDRAW WIRE



Tin coated copper wire for electrical cables and electrical applications



BENEFITS:

Save time and money:

MM Kembla continues its long tradition of supplying quality feed material to domestic and international cable manufactures.

Our Tin Coated Copper Redraw Wire is produced by the latest electrolytic tin coating technology using the renowned Southwire Continuous Cast Copper Rod that is produced on site.

These proven technologies and processes produce wire that consistently exceeds all standards for conductivity, tin concentricity, adherence and surface quality to ensure consistent drawing capability, corrosion resistance and ease of soldering for our customers applications.



FEATURES:

Recommended for:

MM Kembla has the proven production capacity, quality, experience and technical support to ensure your requirements are met.

The latest Two tonne Spoolless packaging provides a greater continuous length for less joins and changeovers.

Spoolless packs are a self-supporting layer wound pack with an internal cardboard liner with a conical external shape for stability.

Packs are strapped to timber pallets by PVC strapping and stretch wrapped with plastic film for protection.

A removable pay-off device is required to unwind the spoolless pack.

RECOMMENDED FOR

- Cable manufactures requiring higher corrosion protection
- Mining cable
- Marine & offshore cable applications
- Instrument cable
- Specialised Bare conductors
- Electrical cable for soldering applications



Quality
Endorsed
Company

ISO 9001 Lic 0002/01
SAI Global

Technical Bulletin No.D58/05

Gloucester Boulevard,
PO Box 21, Port Kembla NSW 2505
T: 1800 804 631
F: 1800 817 846
E: marketing@kembla.com.au
www.kembla.com.au
ABN 13 003 762 641



SPECIFICATIONS - Tin Coated Copper Redraw Wire

Wire Size	Temper	Packaging Available
1.25mm - 3.60mm	Annealed	Spoolless Pack 1.5 - 2.1 tonnes Dimensions: Diameter 900mm Height 780mm (including pallet) Export 20' FCL 21t (10 packs 2.1t)
0.40mm - 1.63mm	Hard Drawn	22 inch reel 250kg L Type 100kg C Type 50kg A Type 25kg
0.40mm - 1.04mm	Annealed	22 inch reel 250kg L Type 100kg C Type 50kg A Type 25kg

Standards	AS/NZS 1574 ASTM B33 DIN 40500
Tin Coating	up to 20µm
Tin Purity	99.95% Sn

SPOOL DIMENSIONS

Dimensions in mm	Flange	Internal Bore	Traverse	Overall Width
22 Inch	560	125	275	320
L Type	355	30	220	275
C Type	315	128	255	280
A Type	235	135	170	197

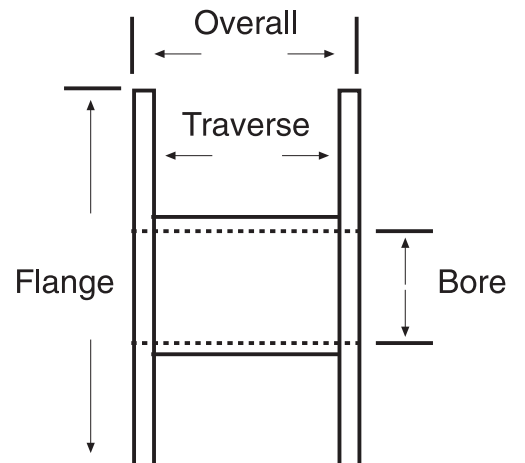

KEMBLA
TIN COATED COPPER REDRAW WIRE